

SCHONBEK®

SCHONBEK IS A WORLD LEADER IN
CHANDELIER DESIGN. PATENTS INCLUDE:
#5,460,269

CHANDELIER 6815-____S TRIM DIAGRAM

(Finish Option)

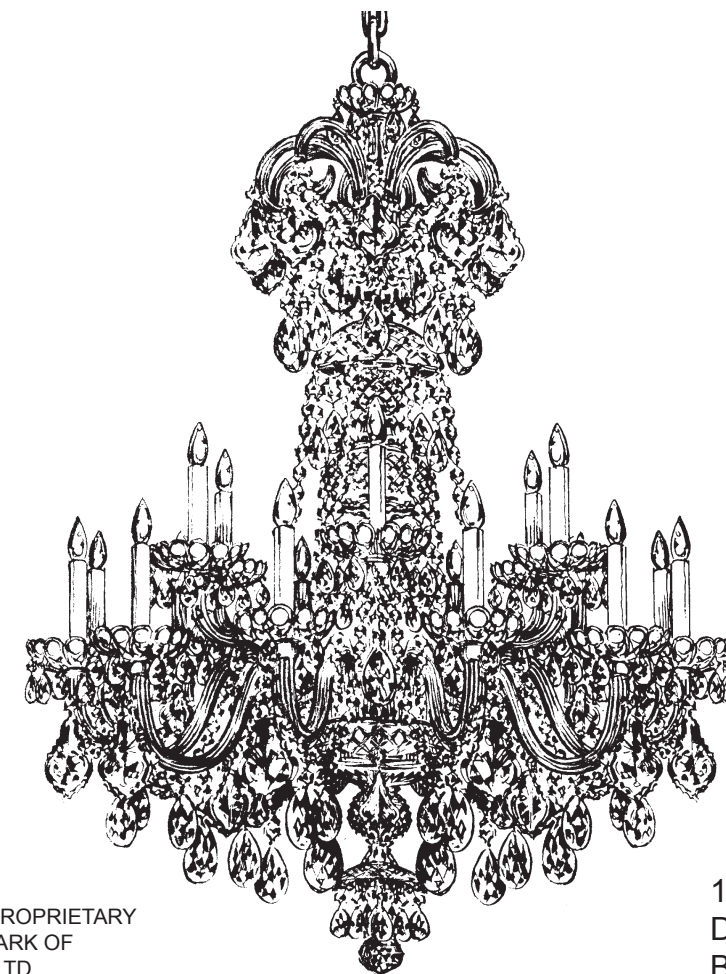

THIS DESIGN IS THE PROPRIETARY
TRADE DRESS/TRADEMARK OF
SWAROVSKI LIGHTING, LTD.

18 + 5 Lights
Diameter: 36"
Body Length: 52"

SCHONBEK®

CAUTION... RISK OF ELECTRICAL SHOCK. Make sure the electrical supply to the chandelier is turned off at the main fuse or circuit breaker before doing any installation. All electrical components must be installed by a licensed electrician in accordance with the National Electric Code and the appropriate local electrical codes.

HANGING WEIGHT: 80 pounds.

BULBS: (5) Tubular shaped candelabra base C7 bulbs, 7-1/2 Watt Maximum.
(18) Candle shaped candelabra base B10 bulbs, recommend 25 watts
for best appearance.
60 - Watts Maximum

WARNING: This chandelier meets UL/CSA requirements. Any tampering will void UL/CSA certification.

Follow steps in exact order
Save this trim diagram for future reference

1

IMPORTANT

Please record the following information for future service.

CODE # _____ Four-digit number on outside of carton.
PACKER # _____ See crystal package label.
ORDER # _____ See crystal package label.

Instructions for electrician STEPS 2 - 7

WARNING: THIS LUMINAIRE MUST BE MOUNTED OR SUPPORTED INDEPENDENTLY OF AN OUTLET BOX.

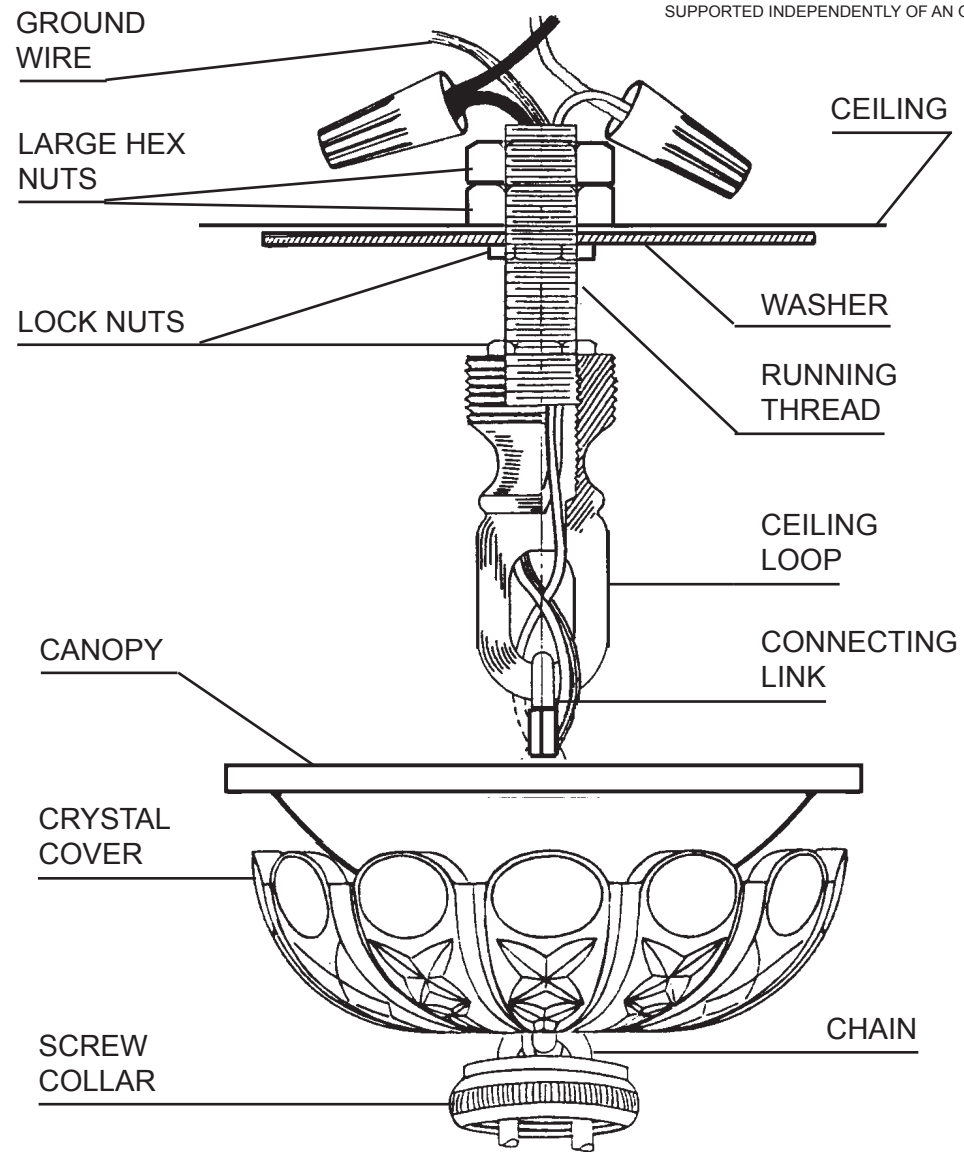

2 MAKE SURE POWER IS DISCONNECTED!!

3 Attach washer to supporting member in ceiling sufficient to support weight of fixture.

4 Slip screw collar, prismatic cover and metal canopy over chain. Determine the suspension length of the fixture and cut chain, if necessary. Use two connecting links to attach chain to chandelier loop and ceiling loop.

5 Insert stem wire through chain and ceiling loop. Connect wires. Fixture **MUST** be grounded.

6 Check distance from ceiling to loop to assure canopy assembly will be flush against ceiling.

7 Attach canopy to ceiling with screw collar.

FRAGILE:

CAUTION: Glass parts are fragile. To avoid breakage use care when assembling or cleaning.

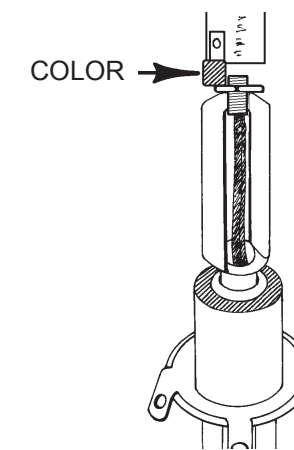

WHEN ORDERING REPLACEMENT ARM(S):

- | Give arm number from trim diagram
- | Give color code from the arm itself

MAINTENANCE:

Use a soft, lint - free cloth to clean the metal frame.

UNDER NO CIRCUMSTANCES SHOULD METAL POLISHES, CLEANERS, ABRASIVES OR AEROSOL SPRAYS BE USED.

While the latest finishing techniques have been used on the metal frame, such finish cannot be unconditionally guaranteed. The main cause of deterioration, apart from certain atmospheric conditions, is improper cleaning.

To clean the crystals, polish with a damp chamois.

You are cleaning delicate jewelry... Take the greatest care.

IMPORTANT:

Do not clean crystals in a dishwasher. The finish of the metal clips and hangers will be ruined and the crystals may be damaged.

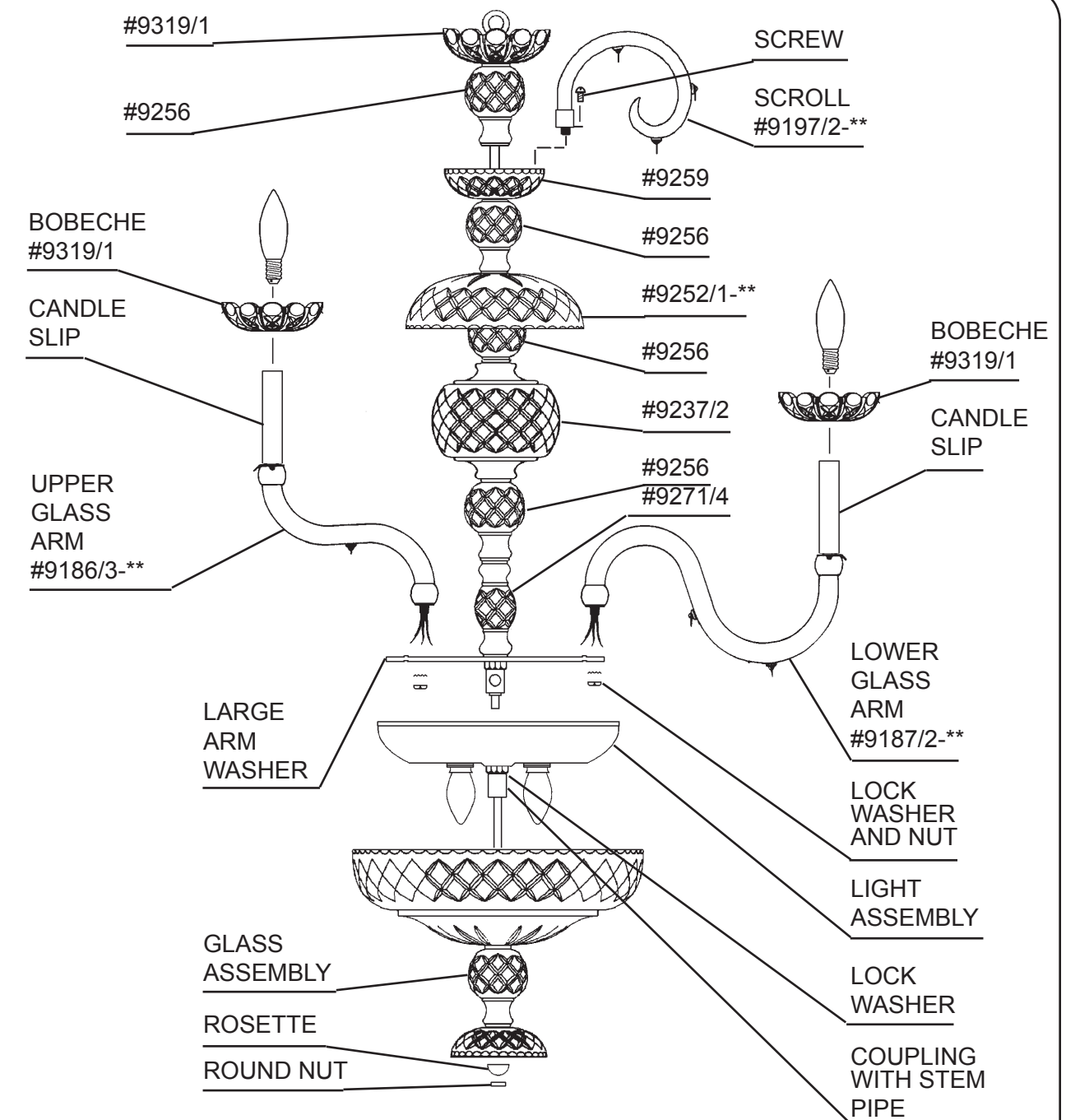

8 Install scrolls into washer with screws provided. Install arms into large arm washer. Line up holes in arms with dimple in washer. Use lock washer and nut to secure arms in place. **NOTE: 6 Upper arms into inside diameter holes and 12 lower arms into outside diameter holes.** Connect bare ground wires in each arm to bare ground wire in center column. Use electrical tape to secure wire nuts. **NO MORE THAN 5 - WIRES PER WIRE NUT.** Sufficient quantities of jumper wires and wire nuts are provided.

9 Connect white arm wires to neutral column wire (ribbed or marked is neutral). Connect black arm wires to power wire in column. Carefully press wires as close as possible to the underside of washer.

10 Attach light assembly with lock washer and coupling with stem pipe. Install 5 - C7 bulbs. Attach glass assembly with rosette and round nut.

11 Install bobèches and bulbs, connect power and test the fixture BEFORE trimming. If any of the bulbs do NOT light - DISCONNECT POWER. Double check the wire connections.

Instructions for crystal trimming STEPS 12 - 26

- 12** Hook Crystal "G" into bracket on upper column bobèche.
- 13** Hook Crystal "G" into the inside ring on glass scroll.
- 14** Hook Crystal "A" into the lower ring on glass scroll. Hook Chain "C" into the loops on Crystal "A". Chain "C" are swagged between Crystal "A".
- 15** Hook Crystal "B" into the upper ring on glass scroll. Hook Chain "C" into the loops on Crystal "B". Chain "C" are swagged between Crystal "B".
- 16** Hook Chain "D" into every other ring on the center column bobèche. Chain "D" hangs between two lower arms. Hook Crystal "H" into center loops on Crystal "D".
- 17** Hook Crystal "E" into every other ring on the center column bobèche. Crystal "E" hangs above upper arm.
- 18** Hook Chain "J" into side loops on Chain "D". Hook other end into side tab under bobèche on lower arm. Chain "J" swagged between Chain "D" and **where two lower arms are side by side.**
- 19** Screw Crystal Ball "F" onto the bottom of chandelier. Tighten setscrew with allen wrench provided to lock ball into position.
- 20** Hook Crystal "G" into rings on the lower column bobèche.
- 21** Hook Crystal "K1" into ring on upper arm.
- 22** Hook Crystal "M" into center tab under upper arm bobèche.
- 23** Hook Crystal "H1" & "N" of each into the rings on lower arm.
- 24** Hook Crystal "O" into center tab under the lower arm bobèche. Hook Chain "P" into side loops on Crystal "O". Chain "P" swagged between Crystal "O".
- 25** Hook Chain "Q" into side tab under upper arm bobèche. Hook other end into side tab under lower arm bobèche. Chain "Q" swagged between upper and **where an upper arm is between two lower arms.**
- 26** Every bobèche is trimmed with Crystal "G", one suspended from every bracket.

