

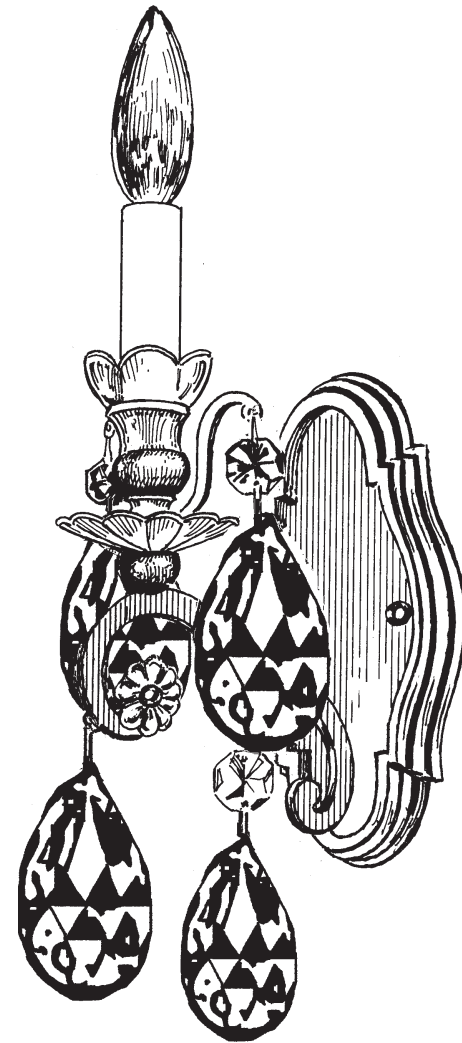

**SCHONBEK®**

**RENAISSANCE 3756- \_\_\_\_\_**



1 Light  
Diameter: 6"  
Body Length: 15-1/2"  
Extension: 5-1/2"  
Hanging Weight: 3-1/2 lbs.

**T**HIS DESIGN IS THE PROPRIETARY  
TRADE DRESS/TRADEMARK OF  
SWAROVSKILIGHTING, LTD.



**SCHONBEK®**

MAX <b>60</b> W		110-120 V						

SCHONBEK® is a member of the Swarovski group.

All electrical components must be installed by a licensed electrician in accordance with the National Electric Code and the appropriate local electrical codes.

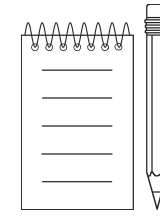
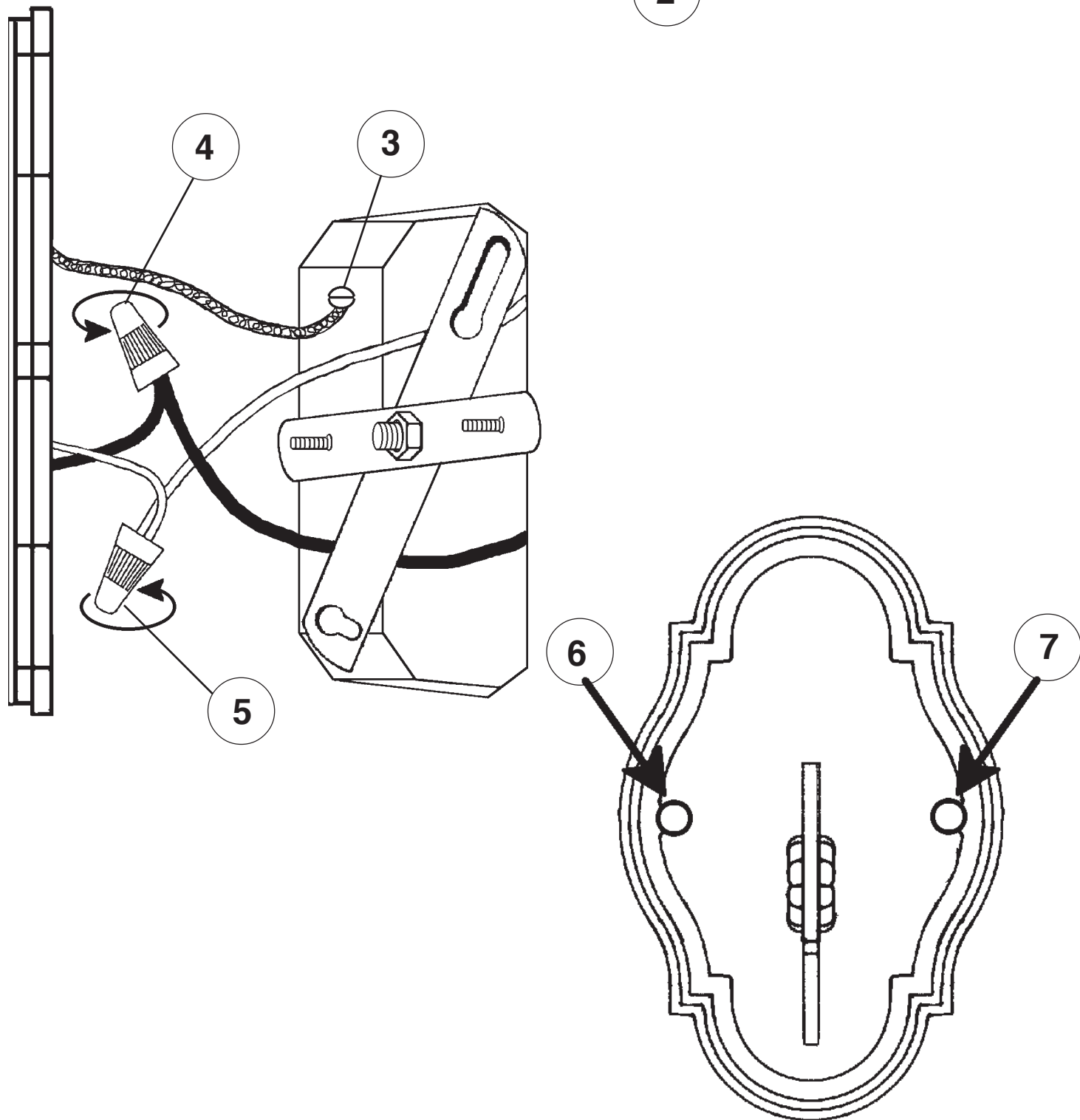
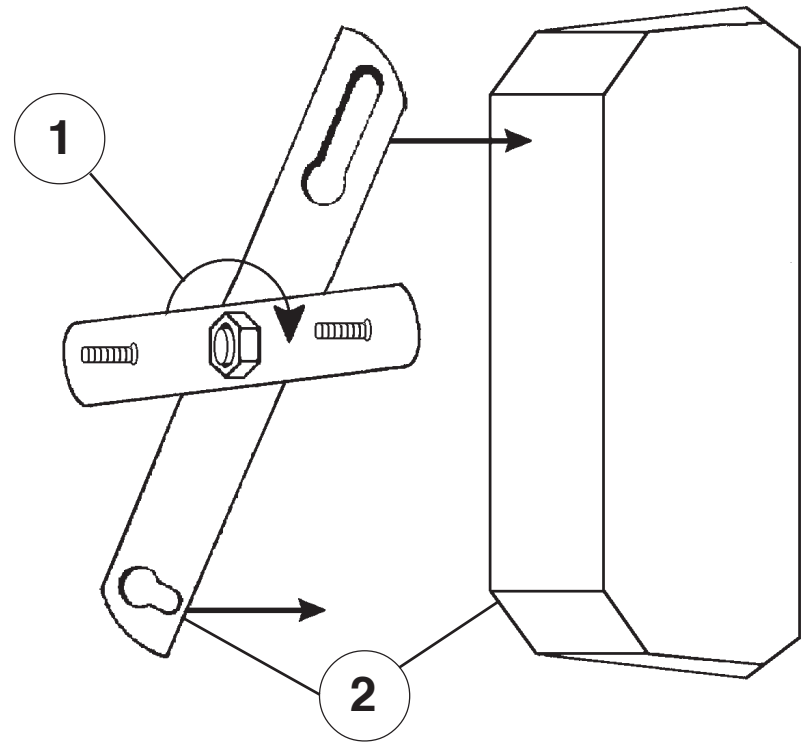

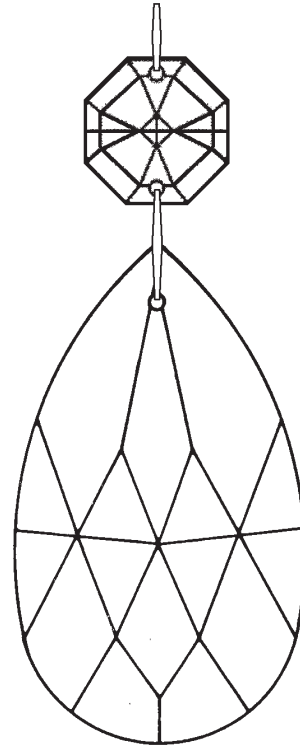
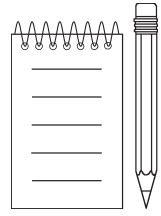

**N4000-\*\***  
3"  
76mm

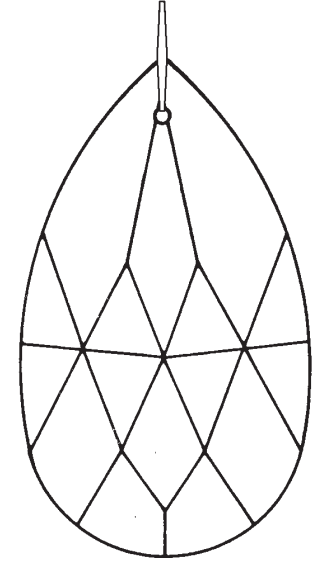

**N4004-\*\***  
3"  
76mm

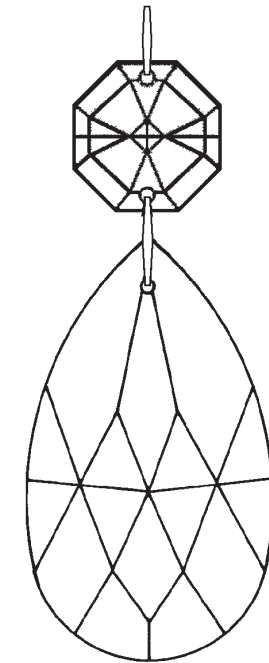

**N4003-\*\***  
2-1/2"  
63mm

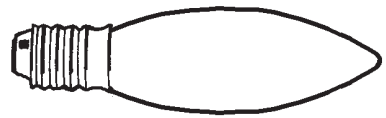

9

You will need 1 - B10  
25 Watts Recommended  
60 Watts Max

Install bulb and be sure  
to test fixture **BEFORE**  
trimming.

